

KOLB Classic



Kolb Design Technology

Giving ideas and visions physical shape

The history of Kolb begins in 1890 with Franz Kolb, a Munich pharmacist and the inventor of plasticine. The resulting company has been a supplier of modelling materials for more than 100 years. Since the 1980s, the main focus has been styling clay, especially for automotive design studios.

In 2001 Kolb Technology was founded to fulfil the needs of modern modelling and build a bridge between handcraft and digital world. With the innovative StudioLine milling machines and an excellent service Kolb became a renowned player in the industry within a few years.

In 2011 Kolb took over the portfolio of its former mother company. Clay, tools and modelling equipment completed Kolb's portfolio and made Kolb the central contact for everything about clay styling. As a supplier of clay and tools Kolb has a strong connection to traditional model building.

2015 Kolb became part of the STREICHER group and now operates under the new name Kolb Design Technology GmbH & Co. KG.

For more information about the STREICHER group visit www.streicher.de

Contact

For more information or orders please do not hesitate to contact us.

Kolb Design Technology GmbH & Co. KG
Josef-Wallner-Str. 5a
94469 Deggendorf
Germany
Tel +49 99 1 / 344 739-0
Fax +49 99 1 / 344 739-290
E-mail: info@kolb-technology.com

For many years this clay has been the standard in design studios all over the world. The big advantage of SuperClay in comparison to competitor clays is its ability to hold sulphur. While other clays must be heated to 63 - 65 degrees and exude sulphur, our clay keeps the sulphur bonded. The reasons for this are the moderate processing temperature of our clay, the way we produce it and of course the well chosen ingredients. SuperClay is available in a medium and a hard version.

Characteristics

- SuperClay® is perfectly soft when removed from the oven at 58° Celsius. Nevertheless it provides a hard surface and stable edges at 20° Celsius.
- SuperClay® is perfect for milling. Additionally it shows excellent manual modelling properties and an excellent surface finish.
- SuperClay® does not have to cool down to 20° Celsius for processing. It can be worked with slicks and tools while it is still warm.
- SuperClay® models are solid enough to use screws, nails or needles to fix hang-on parts.
- SuperClay® is evacuated, homogenized and odourless.
- SuperClay® doesn't age or oxidize. It is colour-stable and the model will not get oily or blotchy.
- SuperClay® is available in the Kolb typical shape of bars. This shape allows a very compact, space-saving packing. One box contains 20 bars which are perfectly protected by the packing and easy to handle.

Application

Modelling up to full-scale models. Suitable for cantilever and hollow parts. SuperClay® provides excellent machining results.

Price and order information

art.no.	description	sales unit	price per piece	
11903	brown, 1kg/bar, 700ccm/bar	20 kg / box	from 20 pcs.	on request
			from 200 pcs.	on request
			from 600 pcs. (= 1 pal.)	on request

Also available as „SuperClay hard“ (art. no. 11913). This type is particularly suitable for milling.



TecClay is a sulphur-free light-clay which reaches its perfect working temperature at 55 degrees Celsius already. As TecClay is 40% lighter than ordinary clay, the final models are also much lighter. The complex production of TecClay and its well chosen thermic ingredients have the result that this clay keeps all its ingredients extremely well bonded. TecClay will not exude components: the model stays nice for a long time, it will not get greasy or blotty. Beside it shows an extreme color-stability - your presentation models will look better than ever.

Characteristics

- TecClay® is 100% sulphur-free.
- TecClay® has 40% less weight than ordinary clay at the same volume (700ccm per billet). This will not only result in lighter models, but also reduce your shipping costs.
- TecClay® has a very low expansion coefficient. Thermal fluctuation will only result in insignificant expansion respectively shrinkage and therefore cracks are most unlikely.
- TecClay® shows an excellent surface finish. The clay can easily be smoothed with slicks - without annoying stroke traces or scratches.
- TecClay® is edge stable, has excellent adhesive properties and is perfect for interior and high detail models.
- TecClay® shows excellent milling qualities. The millings are dry and will easily come off the model.
- TecClay® doesn't age or oxidize and is odourless.
- TecClay® is extremely colour consistent. Changes on an old model are possible without colour variation.
- Heated TecClay® is not only much softer than competitive products and therefore easier to work with, it will also not wear off your tools and slicks as fast.

Application

Modelling up to full-scale models. Suitable for cantilever and hollow parts. TecClay provides excellent machining results.

Price and order information

art.no.	description	sales unit	price per piece	
11914	light-brown, 0,6kg/bar, 700ccm/bar	20 pcs. / box	from 20 pcs.	on request
			from 200 pcs.	on request
			from 600 pcs. (=1 pal.)	on request



InDeClay (Industrial Design Clay) was created to fulfil especially the needs of industrial designers. It is a light grey clay which bases on Kolb's TecClay and shows because of its colour extremely well shadows and highlights. InDeClay is also the perfect material for character designers.

Characteristics

- InDeClay is 100% sulphur-free.
- InDeClay has 40% less weight than ordinary clay at the same volume (700ccm per billet). This will not only result in lighter models, but also reduce your shipping costs.
- InDeClay models appear light and elegant and are therefore perfect for presentations. The light grey color gives a unique quality to the models and fine details, shadows and highlights are easy to spot.
- InDeClay does not show light-coloured traces after the use of steels. The model is immediately „ready“ and shows a color-homogeneous surface. In many cases lacquering is not necessary.
- InDeClay models are perfect for the follow up in the computer due to their colour. Photos of the models can easily be colored or enhanced in Photoshop. The light-grey and fine details emphasizing models are also a perfect base for the creation of digital 3D-models.
- InDeClay is edge stable and perfect for the creation of high detail models.
- InDeClay doesn't age or oxidize and is odourless.
- InDeClay has excellent adhesive properties.

Application

Modeling and form creation in Product Design, Transportation Design and Character Design.

Price and order information

art.no.	description	sales unit	price per piece	
11912	light-grey, 0,6kg/bar, 700ccm/bar	20 pcs. / box	from 20 pcs.	on request
			from 200 pcs.	on request
			from 600 pcs. (= 1 pal.)	on request



ProfilClay is a black and highly flexible clay type, which is perfect for extrusion and mainly used for the imitation of rubber strips and profiles. Of course ProfilClay may also be used for ordinary modelling.

Characteristics

- ProfilClay is homogenized which avoids air-bubbles when extruded.
- ProfilClay is very flexible and may be more than 45° without tearing or breaking.
- ProfilClay aligns perfectly with the surface and has great modelling properties.
- ProfilClay is stable and windtunnel-proof.
- ProfilClay doesn't age or oxidize.
- ProfilClay is odourless and free of harmful substances.
- ProfilClay is sulphur-free.

Application

Imitating rubber-profiles.

Price and order information

art.no.	description	sales unit	price per bar	
12011	black, 2kg/bar, 1580ccm/bar	16 kg / box (8 bars)	from 16 kg	on request
			from 160 kg	on request
			from 480 kg (=1 pal.)	on request



SilverPeel is an easy to handle, silver-coloured, water-based peel-off paint.

In dry state it can easily be peeled off from models without affecting the clay surface. SilverPeel can also be applied on plastics, sheet metals and all smooth surfaces.

A quick, cheap and easy to use alternative to Dynoc films.

Characteristics

- SilverPeel is perfect for the use on clay or other waxen surfaces.
 - SilverPeel can be brushed or sprayed.
 - SilverPeel sticks in gorges and can be sprayed on surfaces which are hard to reach with folio products.
 - SilverPeel turns into a film and should be applied in several layers.
 - SilverPeel can be filled in dried state.
 - SilverPeel is free of aggressive solvents and is not subject to specific labelling.
 - SilverPeel can be used indoors.
 - SilverPeel is soluble with cold water. Remains of SilverPeel lacquering can easily be washed off.
 - SilverPeel is also suitable as a separation layer in foam molds.
- A video about the use of SilverPeel can be viewed on our website in the section products/classics/SilverPeel.

Application

Temporary lacquering of clay models for quick design presentations. Avoids time-consuming and costly use of Dynoc.

Price and order information

art.no.	sales unit	price per piece
11608	750ml bottle	36,60 €



ClayPeel is an easy to handle, blue-coloured, water-based peel-off paint.

In dry state it can easily be peeled off from models without affecting the clay surface. Except for its mat blue color ClayPeel is identical with SilverPeel. ClayPeel is used as a removable interlayer, which can be coated with ordinary paint. This interlayer allows the removal of ordinary paint/lacquering from the clay-surface without damage.

Characteristics

- ClayPeel is perfect for the use on clay or other waxen surfaces.
- ClayPeel can be brushed or sprayed.
- ClayPeel sticks in gorges and can be sprayed on surfaces which are hard to reach with folio products.
- ClayPeel turns into a film and should be applied in several layers.
- ClayPeel can be filled or overlacquered in dried state.
- ClayPeel is free of aggressive solvents and is not subject to specific labelling.
- ClayPeel can be used indoors.
- ClayPeel is soluble with cold water. Remains of ClayPeel lacquering can be easily washed off.
- ClayPeel is also suitable as a separation layer in foam molds.

- A video about the use of ClayPeel can be viewed on our website in the section products/classics/SilverPeel & ClayPeel.

Application

Base coat for temporary lacquering of clay models with ordinary paint. Avoids time-consuming and costly use of Dynoc.

Price and order information

art.no.	sales unit	price per piece
11605	750ml bottle	36,60 €



SUBSTRUCTURE 3D-Block light

3D-Block light is an extremely light and grey polystyrene extruded foam which is perfect for the substructure of clay models. Of course 3D-Block light fulfils all usual norms and environmental directives.

Characteristics

- 3D-Block light shows high stiffness and mechanical durability. The advantageous mass-performance-ratio is the result of plates with low weight and high firmness.
- 3D-Block light produces flake-like chips during milling. Fine dust particles, which are common when you use other foams, are reduced to a minimum.
- 3D-Block light reduces the weight of the whole model. In combination with light-weight TecClay® your models become much lighter and therefore more mobile.
- 3D-Block light works best in combination with 3D-Glue.

Price and order information

art.no.	sales unit	price per piece
115181	600x500x160 mm	33,40 €
115182	1200x500x160 mm	66,75 €
11535	3000x500x160 mm	129,60 €

Other types and sizes on request

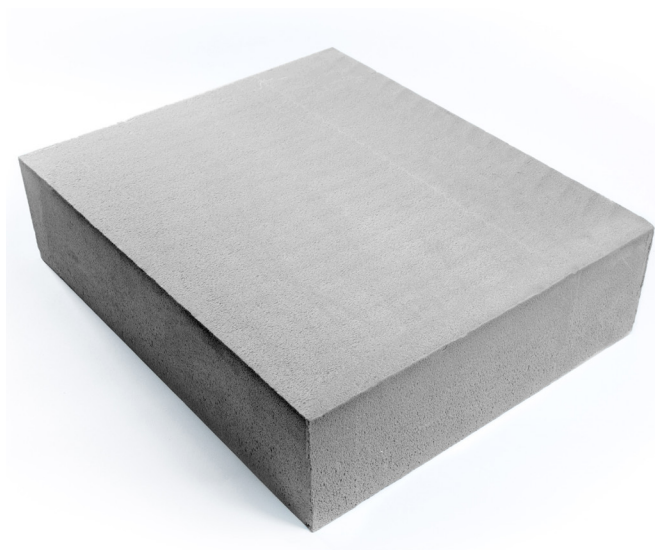

3D-Glue is the all-purpose glue for design modelling. There are only a few things which 3D-Glue does not bond, but many other glues, nails and screws which it will replace.

Characteristics

- 3D-Glue is an easy to use one component polyurethane glue.
- 3D-Glue is perfect for glueing of wood, metal, rigid foam, clay, plastic and lots of other products which are typically used in modelling studios.
- 3D-Glue is viscous and can be poured in gaps which it will fill when hardening.
- 3D-Glue hardens with the help of air humidity and the moisture of the parts which are glued together.
- 3D-Glue can be sprayed with water for faster curing.

Price and order information

art.no.	sales unit	price per piece
11547	750ml bottle (12 bottles/box)	24,72 €
11548	5 ltr. canister (4 canisters/box)	151,62 €



WARMING ClayOven

The ClayOvens type UF Plus by MEMMERT offer exceptional quality in both material and performance. New is the improved version „Plasticine Oven“, especially for the application in clay-design-studios and the fully isolated stainless-steel door with 2-point-door handle and compression door lock.

Due to enforced air circulation the clay will reach the desired working temperature as fast as possible. The clay ovens UF Plus „version plasticine oven“ are available in 3 sizes as full sets for design studios.

Characteristics

- Control temperature exactly between +20 and 300 °C.
- Have proved their reliability during years of application in technical laboratories.
- Easy to clean interior, made of stainless steel.
- Adaptive multifunctional digital PID-microprocessor controller with 2 color displays
- The AtmoControl software of the UF-Plus version enables the programming, managing and transferring of programs



New and modified version „Plasticine Ovens“ for Clay designstudios (special edition)

Interior:	stainless steel W.-St. 1.4301
Shelves:	enforced stainless steel heavy load shelves (Quantity varies according to article and set)
Exterior:	stainless steel, rear panel made of galvanised sheet steel, modified electronic chamber , fully isolated stainless steel door, Twin-Display (TFT color display)
Air circulation:	electrically controlled exhaust flap
Connection:	Schuko power plug according to list below; 4.5 m cord additionally available
Positioning:	four feet, UF 750 Plus (Plasticine oven) is mobile, on lockable castors

Please avoid overloading of the oven to prevent excessive heat!

Price and technical data

article description articel no.			UF 55 Plus (Plasticine) 10561010	UF 260 Plus (Plasticine) 10571010	UF 750 Plus (Plasticine) 10581010
stainless steel interior	volume	ltr.	53	256	749
	width (clear dimensions)	mm	400	800	1040
	height (clear dimensions)	mm	400	640	1200
	depth (clear dimensions)	mm	330	500	600
	support ribs for shelves	number	4	9	14
	shelves (enforced)	number	2	3	7
stainless steel exterior	width	mm	585	824	1224
	height (UF 750 with rolls)	mm	784	1183	1726
	depth (without door-handle, door handle 56 mm)	mm	514	684	784
further data	electrical load (during heating)	approx. W	2000	3400	7000
	electrical supply		230 V 50/60 Hz	230 V 50/60 Hz	400 V 50/60 Hz
	net weight	approx. kg	57	110	217
	gross weight in triwall carton	approx. kg	76	161	288
	packed dimensions (carton) width	approx. cm	73	93	133
	height	approx. cm	95	138	191
	depth	approx. cm	67	93	105
prices	Sets incl. shelves		Set	Set	Set
	all prices without taxes and delivery costs		7.206,00 €	11.621,00 €	19.055,00 €

* All prices are net, plus VAT and freight costs. Prices are subject to change without notice.
Delivery and payment conditions according to our general terms and conditions.

Request for offer

If you want to receive an offer for our products, we kindly request you to fill in the desired amount in the table below. Please also enter your contact details.

Fax this form to **+49 991 / 344 739-290** or send an email to **info@kolb-technology.com**. We will send you an individual offer with delivery time and transport costs as soon as possible.

For requests for slicks, tools, tapes and whetstones please use the forms on the following pages.

art. no.	description	amount		remarks
11903	SuperClay		boxes	
11914	TecClay		boxes	
11912	InDeClay		boxes	
12011	ProfilClay		boxes	
11608	SilverPeel 750 ml		bottles	
11605	ClayPeel 750 ml		bottles	
115181	3D-Block light 600x500x160 mm		pieces	
115182	3D-Block light 1200x500x160 mm		pieces	
11518	3D-Block light 3000x500x160 mm		pieces	
11547	3D-Glue 750 ml bottle		bottles	
11548	3D-Glue 5 l canister		canisters	
10561010	ClayOven UF 55 Plus (Plasticine)		pieces	
10571010	ClayOven UF 260 Plus (Plasticine)		pieces	
10581010	ClayOven UF 750 Plus (Plasticine)		pieces	
* Delivery and payment terms according to our general terms and conditions.				

name		phone	
company		fax	
address		VAT no.	
		date	signature
email			

Modeling Slicks

Prices and order form 2021

article	dimensions LxWxT in mm	price	amount	article	dimensions LxWxT in mm	price	amount
11704	400x80x0,80	19,79 €		11752	200x40x0,20	9,90 €	
11705	360x80x0,80	18,93 €		11753	200x40x0,15	9,94 €	
11706	300x80x0,80	17,84 €		11754	130x30x0,20	8,75 €	
11707	400x60x0,60	16,78 €		11755	130x30x0,15	8,79 €	
11708	340x60x0,60	16,17 €		11756	130x30x0,10	8,79 €	
11709	280x60x0,60	15,45 €		11757	165x35x0,20	8,86 €	
11710	360x60x0,50	16,13 €		11758	165x35x0,15	8,94 €	
11711	300x60x0,50	15,43 €		11759	165x35x0,10	8,87 €	
11713	300x50x0,40	10,03 €		11760	140x35x0,20	8,34 €	
11715	250x40x0,30	7,64 €		11761	140x35x0,15	9,18 €	
11716	200x40x0,30	7,46 €		11762	140x35x0,10	8,34 €	
11717	300x60x0,30	8,60 €		11763	97x30x0,20	6,52 €	
11718	240x60x0,30	8,03 €		11764	97x30x0,15	6,55 €	
11719	200x60x0,30	7,80 €		11765	97x30x0,10	6,56 €	
11720	150x60x0,30	7,85 €		11766	170x40x0,20	9,11 €	
11721	240x60x0,20	6,24 €		11767	170x40x0,15	8,75 €	
11722	200x60x0,20	6,09 €		11768	120x30x0,20	6,55 €	
11723	150x60x0,20	5,91 €		11769	120x30x0,15	6,58 €	
11724	120x60x0,20	5,78 €		11770	85x30x0,15	6,53 €	
11725	200x40x0,20	5,80 €		11771	85x30x0,10	6,48 €	
11726	100x40x0,20	5,54 €		11772	55x20x0,10	6,40 €	
11727	80x40x0,20	5,46 €		11773	45x25x0,10	6,40 €	
11728	150x60x0,15	5,15 €		11774	50x30x0,10	6,40 €	
11729	120x60x0,15	5,05 €		11775	75x35x0,20	6,53 €	
11730	200x40x0,15	5,10 €		11776	75x35x0,10	6,50 €	
11731	100x40x0,15	4,82 €		11777	95x45x0,20	6,60 €	
11732	80x40x0,15	4,77 €		11778	95x45x0,15	6,58 €	
11733	120x60x0,10	4,22 €		11779	120x45x0,20	7,49 €	
11734	100x40x0,10	3,96 €		11780	120x45x0,15	7,51 €	
11735	80x40x0,10	3,91 €		11781	60x45x0,15	6,48 €	
11736	360x75x0,80	25,16 €		11782	60x45x0,10	6,53 €	
11737	250x55x0,50	14,11 €		11783	75x40x0,15	6,53 €	
11738	250x55x0,40	13,40 €		11784	75x40x0,10	6,58 €	
11739	250x55x0,30	13,60 €		11785	90x50x0,20	6,67 €	
11740	250x55x0,20	13,10 €		11786	90x50x0,10	6,70 €	
11741	180x55x0,30	10,38 €		11787	85x45x0,20	6,60 €	
11742	180x55x0,20	10,14 €		11788	85x45x0,10	6,66 €	
11743	180x55x0,15	10,24 €		11789	65x40x0,15	6,48 €	
11744	180x40x0,20	9,19 €		11790	65x40x0,10	6,58 €	
11745	180x40x0,15	9,22 €		11791	140x55x0,30	9,67 €	
11746	285x50x0,30	13,72 €		11792	300x50x0,30	19,61 €	
11747	239x50x0,20	12,87 €		11793	240x50x0,30	13,60 €	
11748	195x50x0,20	9,73 €		11794	85x55x0,20	6,80 €	
11749	195x50x0,15	9,73 €		11795	85x55x0,10	6,84 €	
11750	150x50x0,20	9,05 €		11797	195x55x0,30	10,11 €	
11751	150x50x0,15	9,01 €					

* All prices are net, plus VAT and freight costs. Prices are subject to change without notice. Delivery and payment conditions according to our general terms and conditions.

name		phone	
company		fax	
address		VAT no.	
		date	signature
email			

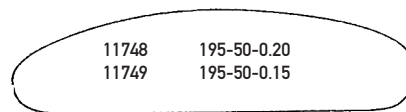
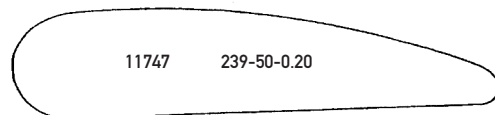
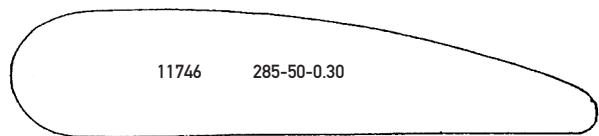
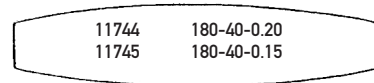
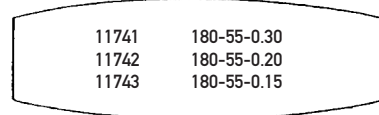
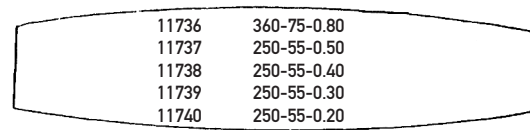
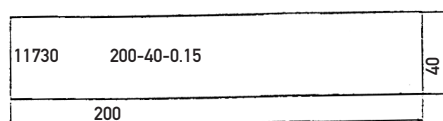
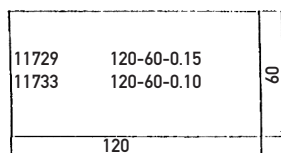
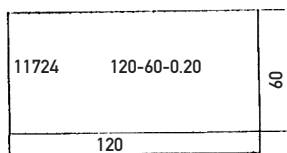
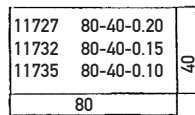
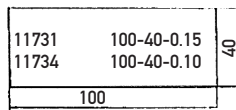
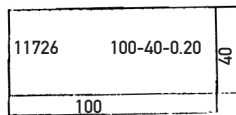
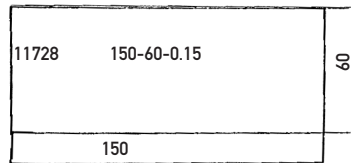
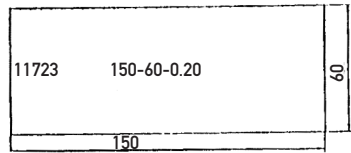
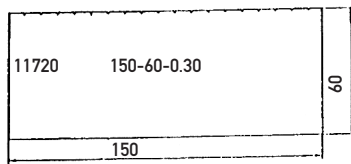

11751 150-50-0.15

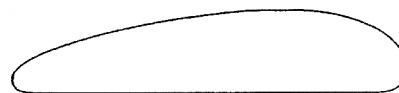

11753 200-40-0.15

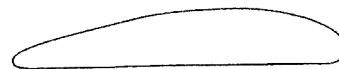

11755 130-30-0.15

11756 130-30-0.10

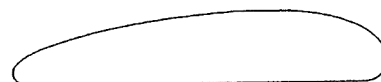

11758 165-35-0.15

11759 165-35-0.10

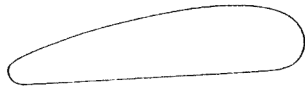

11760 140-35-0.20
11761 140-35-0.15
11762 140-35-0.10



11773 45-25-0.10



11774 50-30-0.10

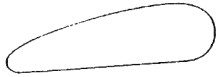

11763 97-30-0.20
11764 97-30-0.15
11765 97-30-0.10



11775 75-35-0.20
11776 75-35-0.10



11777 95-45-0.20
11778 95-45-0.15



11766 170-40-0.20
11767 170-40-0.15



11779 120-45-0.20
11780 120-45-0.15



11768 120-30-0.20
11769 120-30-0.15



11770 85-30-0.15
11771 85-30-0.10



11772 55-20-0.10

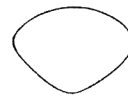

11781 60-45-0.15
11782 60-45-0.10



11783 75-40-0.15
11784 75-40-0.10



11787 85-45-0.20
11788 85-45-0.10



11789 65-40-0.15
11790 65-40-0.10

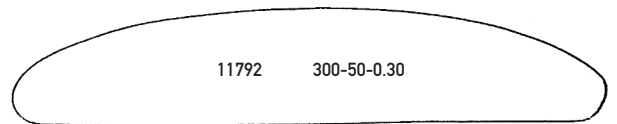

11792 300-50-0.30

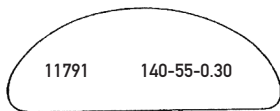

11791 140-55-0.30

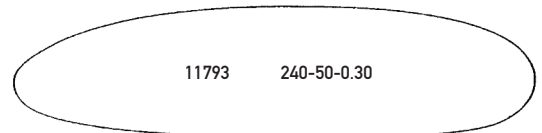

11793 240-50-0.30



11794 85-55-0.20
11795 85-55-0.10

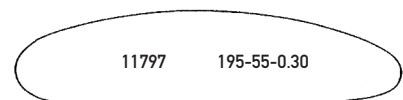

11797 195-55-0.30

Spring Steel

Prices and order form 2021

If you prefer to make modelling slicks on your own, our spring steel strips are perfect for you. The blue hardened spring steel in C100S quality can be bought by the meter.

art.no.	description	price per metre	order amount in metre
15401	spring steel 40mm x 0,10mm	4,02 €	
15402	spring steel 40mm x 0,15mm	4,40 €	
15403	spring steel 40mm x 0,20mm	4,28 €	
15404	spring steel 40mm x 0,30mm	5,27 €	
15405	spring steel 50mm x 0,15mm	5,78 €	
15406	spring steel 50mm x 0,20mm	5,64 €	
15407	spring steel 50mm x 0,40mm	7,76 €	
15408	spring steel 60mm x 0,10mm	6,63 €	
15409	spring steel 60mm x 0,15mm	6,46 €	
15410	spring steel 60mm x 0,20mm	6,51 €	
15411	spring steel 60mm x 0,30mm	7,92 €	
15412	spring steel 60mm x 0,50mm	11,28 €	
15413	spring steel 60mm x 0,60mm	12,93 €	
15414	spring steel 72mm x 0,30mm	10,89 €	
15415	spring steel 80mm x 0,40mm	10,88 €	
15416	spring steel 80mm x 0,80mm	16,56 €	

* All prices are net, plus VAT and freight costs. Prices are subject to change without notice. Delivery and payment conditions according to our general terms and conditions.

name		phone	
company		fax	
address		VAT no.	
		date	signature
email			

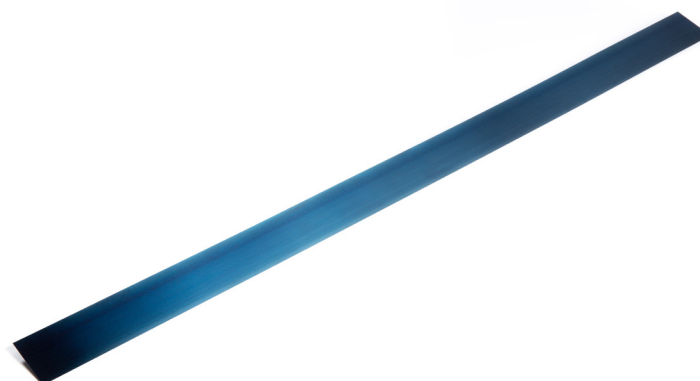

Carbon Splines

Prices and order form 2021

Kolb's new carbon splines are highly stable and an alternative to traditional splines or a completion to our steels.

In respect to wooden splines they are by far superior when it comes to durability, edge stability, flexibility and weight. The perfect and extremely hard edges lead to great modelling results..

art.no.	description	price per piece	order amount
11860	Carbon Spline 1,0mm x 90mm x 500mm	50,48 €	
11861	Carbon Spline 1,0mm x 60mm x 1000mm	67,55 €	
11862	Carbon Spline 2,0mm x 90mm x 500mm	87,22 €	
11863	Carbon Spline 2,0mm x 60mm x 1000mm	102,39 €	
11864	Carbon Spline 4,0mm x 90mm x 1000mm	326,62 €	
11866	Carbon Spline 4,0mm x 90mm x 1500mm	447,94 €	
* All prices are net, plus VAT and freight costs. Prices are subject to change without notice. Delivery time approx. 2 weeks after incoming order. Delivery and payment conditions according to our general terms and conditions.			

name	phone	
company	fax	
address	VAT no.	
	date	signature
email		



* All prices are net, plus VAT and freight costs. Prices are subject to change without notice. Delivery and payment conditions according to our general terms and conditions.

article	unit	price	order amount
114002	per piece	50.00 €	
114004	per piece	50.00 €	
114005	per piece	50.00 €	
114006	per piece	50.00 €	
114007	per piece	50.00 €	
114009	per piece	55.00 €	
114024	per piece	57.00 €	
114025	per piece	57.00 €	
114028	per piece	57.00 €	
114031	per piece	57.00 €	
114032	per piece	57.00 €	
114036	per piece	59.00 €	
114038	per piece	59.00 €	
114039	per piece	59.00 €	
114101	per piece	51.00 €	
114102	per piece	50.00 €	
114103	per piece	51.00 €	
114104	per piece	51.00 €	
114105	per piece	51.00 €	
114106	per piece	50.00 €	
114107	per piece	50.00 €	
114108	per piece	51.00 €	
114118	per piece	50.00 €	
114119	per piece	98.00 €	
114120	per piece	102.00 €	
114121	per piece	50.00 €	
114122	per piece	50.00 €	
114125	per piece	76.00 €	
114126	per piece	84.00 €	
114127	per piece	51.00 €	
114128	per piece	51.00 €	
114200	per set (for 1;2;3;4;5mm joints)	314.00 €	
114201	per piece (for 1mm joints)	72.00 €	
114202	per piece (for 2mm joints)	72.00 €	
114203	per piece (for 3mm joints)	72.00 €	
114204	per piece (for 4mm joints)	72.00 €	
114205	per piece (for 5mm joints)	78.00 €	
114217	per piece	23.00 €	
114300	per piece	202.00 €	
11812	per piece	37.00 €	
11813	per piece	33.00 €	
11814	per piece	42.00 €	
11598	per piece with tools	2.273.00 €	
11599	per piece without tools	255.00 €	
11850	per piece	691.00 €	
11851	per piece	849.00 €	

name		phone	
company		fax	
address		VAT no.	
		date	signature
email			



114002
50.00 €
width: 14mm



114004
50.00 €
width: 9mm



114005
50.00 €
width: 11mm



114006
50.00 €
width: 5mm



114007
50.00 €
width: 10mm



114009
55.00 €
width: 4mm



114024
57.00 €
width: 24mm



114025
57.00 €
width: 35mm



114028
57.00 €
width: 40mm



114031
57.00 €
width: 62mm



114032
57.00 €
width: 50mm



114036
59.00 €
width: 45mm



114038
59.00 €
width: 40mm



114039
59.00 €
width: 36mm



114101
51.00 €
width: 70mm
height: 33mm



114102
50.00 €
width: 75mm
height: 28mm



114103
51.00 €
width: 65mm
height: 29mm



114104
51.00 €
width: 73mm
height: 32mm



114105
51.00 €
width: 70mm
height: 34mm



114106
50.00 €
width: 50mm
height: 35mm



114107
50.00 €
width: 73mm
height: 25mm



114108
51.00 €
diameter: 35mm



114118
50.00 €
width: 40mm
height: 10mm
teeth on one side



114119
98.00 €
width: 65mm
height: 19mm
teeth on one side



114120
102.00 €
width: 150mm
height: 19mm
teeth on one side



114121
50.00 €
width: 30mm
height: 15mm



114122
50.00 €
width: 61mm
height: 15mm



114125
76.00 €
width: 43mm
height: 13mm
teeth on one side



114126
84.00 €
width: 75mm
height: 11mm
teeth on one side



114127
51.00 €
width: 56mm
height: 14mm



114128
51.00 €
width: 56mm
height: 14mm



114201
72.00 €
joint tool 1mm



114202
72.00 €
joint tool 2mm



114203
72.00 €
joint tool 3mm



114204
72.00 €
joint tool 4mm



114205
78.00 €
joint tool 5mm



114217
23.00 €
wax knife
width: 9mm
length: 178mm



114300
202.00 €
Profilmeister 5-part
(snap-together,
with case)
width: 85mm
length: 200mm (x 5)



11812
37.00 €
clay planer made of
aluminium
width: 30mm
length: 155mm



11813

33.00 €

small WindowMouse made of aluminium, width: 20mm, length: 90mm

11814

42.00 €

big WindowMouse made of aluminium, width: 30mm, length: 150mm

11598

2273.00 €

Kolb tools in
wooden case

(art.no. 114002-114205)



11850

691.00 €

radius set made of acrylic
incl. wooden case

11851

849.00 €

radius set made of aluminium
incl. wooden case

Tool and Slick Sets

Prices and order form 2021

We bundled our most popular tools and slicks into sets. Perfect for everybody looking for basic equipment.

art.no.	description	price p. set	order amount
21560100	Set PRO contains the following slicks: 11711, 11726, 11735, 11761, 11774, 11792 and the following tools: 114024, 114028, 114119, 114120, 114125	435,30 €	
21560101	Set WORK contains the following slicks: 11726, 11735, 11761, 11774, 11792 and the following tools: 114024, 114028, 114119, 114120	353,50 €	
2160102	Set START contains the following slicks: 11726, 11735, 11761, 11792 and the following tools: 114024, 114028, 114119	246,60 €	
* All prices are net, plus VAT and freight costs. Prices are subject to change without notice. Delivery time approx. 2 weeks after incoming order. Delivery and payment conditions according to our general terms and conditions.			

name	phone	
company	fax	
address	VAT no.	
	date	signature
email		



Tapes

Prices and order form 2021

art.no.	description	price p. piece	order amount
11930	3mm, crepe, black, 55 m roll	4,08 €	
11931	6mm, crepe, black, 55 m roll	5,02 €	
11932	9,5mm, crepe, black, 55 m roll	5,69 €	
11933	12mm, crepe, black, 55 m roll	6,84 €	
11934	15mm, crepe, black, 55 m roll	7,99 €	
11935	19mm, crepe, black, 55 m roll	9,11 €	
11936	30mm, crepe, black, 55 m roll	13,68 €	
11937	38mm, crepe, black, 55 m roll	20,18 €	
11938	50mm, crepe, black, 55 m roll	22,79 €	
11964	20mm, chrome, 60 m roll	12,35 €	
11965	30mm, chrome, 60 m roll	18,52 €	
11966	40mm, chrome, 60 m roll	28,03 €	
11967	12mm, chrome, 60 m roll	7,42 €	

black crepe tapes are also available in custom-size on request (minimum order amount for custom-sized tape is 50 pieces)

* All prices are net, plus VAT and freight costs. Prices are subject to change without notice.

Delivery time approx. 8 days after incoming order. Custom-sized tapes take longer.

Delivery and payment conditions according to our general terms and conditions.

name		phone	
company		fax	
address		VAT no.	
		date	signature
email			



Clay Modeling Film

Prices and order form 2021

art.no.	description	price p. piece	order amount
11620	clear, 50my, 96cm x 30m	1289,30 €	
11621	silver, 75my, 96cm x 30m	2165,10 €	
11622	black, 75my, 96cm x 20m	2330,60 €	
11623	gunmetal, 75my, 96cm x 20m	2330,60 €	
11624	red, 75my, 45cm x 5m	388,90 €	
11625	red, 75my, 96cm x 5m	755,70 €	
11626	red, 75my, 96cm x 20m	2875,20 €	
11628	white, 75my, 45cm x 5m	388,90 €	
11629	white, 75my, 96cm x 20m	2875,20 €	
11630	timber, maple dark, 96cm x 72,8cm	482,70 €	
11632	steel-grey, 75my, 96cm x 20m	2875,20 €	
11633	black mat effect, 75my, 96cm x 5m	813,70 €	
11634	black mat effect, 75my, 96cm x 20m	3102,80 €	

* All prices are net, plus VAT and freight costs. Prices are subject to change without notice.

Delivery time on request.

Delivery and payment conditions according to our general terms and conditions.

name		phone	
company		fax	
address		VAT no.	
		date	signature
email			

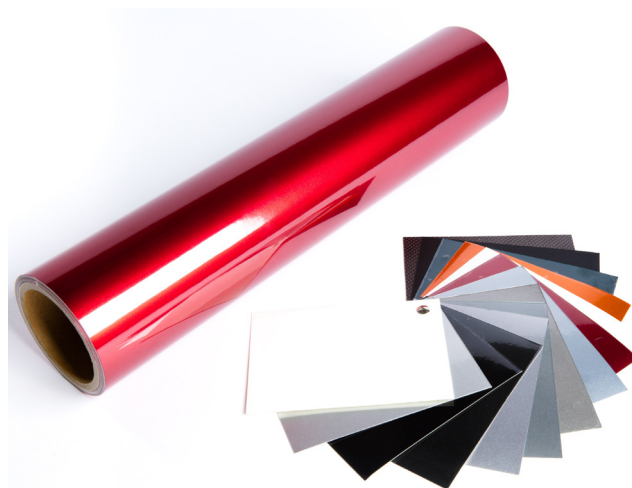

Diamond Whetstones

Prices and order form 2021

- plane - highest surface quality
- easy – light pressure produces a sharp edge with just a few strokes
- durable – produced with high precision for a long lifespan
- clean – use water for lubrication: no oil, no mess!
- gentle – manual sharpening guarantees a long lifespan of your tools

grit	code	mesh	application
extra fine	E	1200	precision tools
fine	F	600	slicks & tools
coarse	C	325	general cutting tools
extra coarse	X	220	fast sharpening

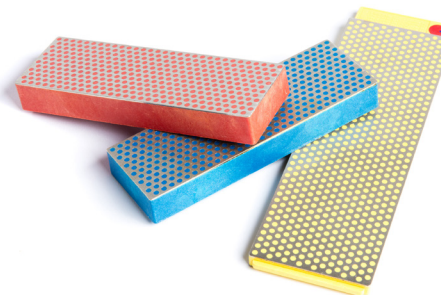

art.no.	model	size	grit	description	price p. piece	order amount
11664	W6EP	150x50	extra fine	6" diamond whetstone one sided, in plastic case	83,64 €	
11665	W6FP	150x50	fine	6" diamond whetstone one sided, in plastic case	83,64 €	
11666	W6CP	150x50	coarse	6" diamond whetstone one sided, in plastic case	83,64 €	
11667	W6XP	150x50	extra coarse	6" diamond whetstone one sided, in plastic case	83,64 €	
11682	W8EF	206x67	extra fine/ fine	D-8" diamond whetstone double sided, in cardboard box	177,24 €	
11683	W8EC	206x67	extra fine/ coarse	D-8" diamond whetstone double sided, in cardboard box	177,24 €	
11684	W8FC	206x67	fine/coarse	D-8" diamond whetstone double sided, in cardboard box	177,24 €	
11685	W8CX	206x67	coarse/extra coarse	D-8" diamond whetstone double sided, in cardboard box	177,24 €	

* All prices are net, plus VAT and freight costs. Prices are subject to change without notice.
Delivery time on request.
Delivery and payment conditions according to our general terms and conditions.

name		phone	
company		fax	
address		VAT no.	
		date	signature
email			

General Terms and Conditions (GTCs)

Kolb Design Technology GmbH & Co. KG
Josef-Wallner-Straße 5 a, 94469 Deggendorf, Germany



Article 1 Scope and exclusivity, interpretation

- (1) These General Terms and Conditions (hereinafter known as GTCs) shall be an integral part of our contractual declaration (contract offer or acceptance) for the conclusion of:
- Purchase contracts (Kaufverträge) where we are the vendor,
 - Contracts for manufacture and supply of goods (Werklieferungsverträge) and contracts for works (Werkverträge), where we manufacture and/or provide the agreed goods or works.
- This shall also apply if additional elements of other contract types are to be agreed, but the contract as a whole is classified as one of the types a) or b) above. In a mixed type contract, these GTCs shall apply to those parts of the contract which are assessed under the contract law for purchase or manufacture and supply or for works and services.
- (2) If our contract partner (client or buyer, hereinafter known as the "Customer") is a consumer (Verbraucher) within the meaning of Article 13 of the German Civil Code (BGB), only Article 1 of these GTCs and those further provisions which are expressly (also) aimed at consumers shall apply.
- (3) Any general terms and conditions as defined in Article 305 (1) sentence 1 of the German Civil Code (BGB) which the Customer sets out in its contractual declarations or to which the Customer refers in any other way shall not become part of the contract. We neither acknowledge such terms and conditions nor do we agree to their applicability. This shall apply even if our reaction to a contractual declaration of the Customer may be deemed an implied acceptance or if we refer to contractual declarations of the Customer without expressly rejecting the terms and conditions of the Customer. Our GTCs shall apply exclusively. However, individual contract agreements between the Customer and us shall not be affected by these GTCs and shall always take precedence.
- (4) Insofar as there are no provisions in individual contractual agreements and these GTCs, the statutory provisions shall be deemed to have been agreed. Insofar as the Customer has provided general terms and conditions which have been effectively incorporated into the contract despite the provision in paragraph 3 above and there is no provision in these GTCs for a circumstance which is governed by the terms and conditions provided by the Customer, the statutory provisions alone shall again be exclusively applicable. These GTCs shall not constitute a waiver of the rights granted to us by law.
- (5) In these GTCs, German words in brackets, shall define the intended meaning in German legal terminology. Wherever the verb "shall" is used it is meant to define a contractual obligation.

Article 2 Offers and conclusion of contract

Paragraphs (1) to (3) shall apply both to consumers and enterprises.

- (1) Our letters and e-mails to the Customer designated as offers or quotations shall be non-binding invitations to enter into contract negotiations unless they are expressly designated as binding or contain a binding period. If an offer designated as binding does not contain a binding period, for e-mails and faxes a binding period of 7 calendar days from their dispatch shall apply, and for letters sent by e-mail a binding period of 10 calendar days from Customer's receipt of the offer shall apply.
- (2) The intended contract shall be set down in writing or at least in text form unless otherwise agreed individually. Any preparations on our part or the commencement of activities to perform the contract shall not be regarded as implied acceptance of the contract, even if we have not expressly reserved our right to accept it.
- (3) Information and details in text form outside the contract documents, for example in our catalogues, advertisements or price lists, as well as any of the properties of exhibited or submitted display items, samples and specimens shall not become part of the contract or form the basis of an agreed quality standard unless specific reference is made to them in the contract documents.

Article 3 Prices

- (1) Unless otherwise agreed, the applicable value-added tax shall be added to the prices and paid by the Customer. Further costs, for example for transport and/or transport insurance as well as costs incurred by customs duties and taxes, shall not be included in the price unless this has been expressly agreed, for example by the use of the appropriate INCOTERMS.
- (2) We shall be entitled to increase prices appropriately at our reasonable discretion according to Article 315 of the German Civil Code (BGB) if the goods or works agreed in the contract shall be delivered or performed after a period of at least four months upon the conclusion of the contract (1st alternative) or if the goods or works can only be supplied or performed with a delay of more than four months due to circumstances which could not be foreseen when the contract was concluded and which is not attributable to our responsibility (2nd alternative). However, this shall only apply to such goods or works for which our manufacturing costs have demonstrably increased by more than 10 % compared to our contract price calculation. In the 1st alternative, the cost increase between the conclusion of the contract and the start of the agreed period of supply or provision shall be decisive for the entitlement of price increase, in the 2nd alternative, the cost

increase between the start of the agreed period of supply or performance and the start of the actual period of supply or performance shall be decisive. However, where fixed prices have been expressly agreed, a price increase under the 1st alternative shall not be possible. The aforementioned rules shall not exclude a judgement by court on this matter pursuant to Article 315 paragraph 3 sentence 2 of the German Civil Code (BGB).

Article 4 Payment, offsetting and assignment of claims

- (1) The Customer shall instruct payments in good time so that we have free access to the funds on the date of maturity (Fälligkeit) in one of the accounts specified by us. All payments shall be made in Euros.
- (2) The Customer may only offset counterclaims if such counterclaims have been established in a court of law, are undisputed or have been acknowledged by us.
- (3) The Customer shall not assign any claims arising from or relating to the contract to third parties without our consent.

Article 5 Time and place of fulfilment and transfer of risk

- (1) If a period of time has been agreed for the performance or the supply, such period shall not commence until the Customer has provided the necessary cooperation, for example it has provided the required information or issued approvals so that we can fulfil our obligation to deliver goods or perform the works. Insofar as nothing has been agreed in this respect, the Customer shall cooperate to the extent commonly expected for the specific contract and according to standard practice in the trade. If the Customer delays such necessary cooperation, the period of supply or performance shall be extended appropriately, by at least the period of the delay.
- (2) Deadlines determined or determinable by calendar day for the supply of goods or performance of works shall not apply if the Customer fails to provide or delays necessary cooperation. Such deadlines shall be replaced by reasonable periods of supply or performance.
- (3) In the event that a hindrance to the performance of the contract occurs, for which neither party to the contract is responsible and which we cannot or cannot fully avert by reasonable measures, the agreed period of supply or performance shall be extended by a reasonable time. Hindrances as mentioned above shall in particular comprise events of force majeure or the effects of such events, for example wars, natural disasters, epidemics or pandemics, embargoes or other import or export restrictions, official measures and orders, industrial action, shortages of the required energy supply, raw materials or purchased components. Measures to avert such hindrances shall in particular be deemed not reasonable if they lead to a cost increase of more than 10 % of the total manufacturing costs for all goods and works, insofar as they are not compensated by the right to increase prices according to Article 3 paragraph (2) hereinabove.
- (4) The place of fulfilment shall be the registered office of our company, unless otherwise agreed.
- (5) We shall be entitled to make partial deliveries/performance in parts if the supply or performance can be reasonably broken down into parts. The Customer shall accept each of these parts unless that is contrary to the objective interest of the Customer due to the nature of the goods or works or the intended use the Customer made us aware of at the time of conclusion of contract.
- (6) Under purchase contracts or contracts for the manufacture and supply the Customer must not refuse reception of the goods if those goods show only minor defects (unerhebliche Mängel). The warranty rights shall not be affected by this provision.
- (7) Under a contract for works, the Customer shall declare partial acceptance at our request for any self-contained parts of the works.

Article 6 Retention of title

- (1) The following shall apply to consumers and enterprises: We herewith retain title to the goods to be delivered according to a purchase contract or a contract for manufacture and supply (goods) until the Customer has settled its consideration or remuneration obligation under the same contract.
- For enterprises, the following paragraphs shall additionally apply:
- (2) The retention of title set out in paragraph (1) shall also secure all other claims from the business relationship that have already arisen when the risk relating to the goods is transferred, irrespective of their maturity. If new claims against the Customer arise during the time the title is retained, such claims shall also be secured by the retention of title, irrespective of their maturity.
- (3) Insofar as the Customer settles the claims, we shall upon each settlement select goods the title to which shall be transferred to the Customer, up to a maximum of the value that corresponds to the amount of settlement. The general release obligation in paragraph (10) shall not be affected by this provision.
- (4) During the period of retention of title, the Customer shall maintain the goods in usable and resalable condition at its own expense, in particular it shall carry out any necessary maintenance and servicing work.

- (5) Unless otherwise stipulated below, the Customer shall neither dispose of the goods nor the claims replacing them (for example against insurance companies) for the whole period of retention of title. The Customer shall notify us immediately in writing of any seizures, confiscations or other interventions by third parties.
- (6) The Customer shall be entitled to process (verarbeiten) or transform (umbilden) the goods in the ordinary course of its business, to combine (verbinden) or mix (vermischen) them with other items and to resell the goods or the newly created item, provided that the Customer's intention to do so was already recognizable to us at the time the contract was concluded and the Customer has assigned to us the claims against third parties arising from the resale as stipulated in paragraph (7). Any processing or transformation shall be carried out by the Customer exclusively on our behalf. In the event of combination or mixing, we shall acquire co-ownership in the new item even if an item other than the goods is deemed to be the main item. Our title of co-ownership shall be determined by the ratio of the market value of our goods to the market values of the other items in the combination/mix. The Customer's expectancy (Anwartschaftsrecht) to the retained title or part of title shall continue in the new item.
- (7) The Customer hereby assigns to us its claims against third parties arising from any resale, namely in the amount corresponding to our claims secured with the retention of title. The same applies to claims against third parties emerging from the loss of or damage to the goods or the new item, for example against insurers or liable parties.
- (8) Without prejudice to our entitlement, the Customer shall remain authorised to collect the assigned claims until further notice. However, we shall not revoke this authorisation or collect the claims ourselves without a justified reason. A justified reason shall in particular be assumed if the Customer defaults on the payment of the secured claims or if there are sufficient indications of grounds for commencing insolvency proceedings against the Customer.
- (9) If the destination of the goods is outside the Federal Republic of Germany and the law of the country of destination does not recognise retention of title or if such retention of title does not have the same protective effect, the Customer shall hereby grant us security for our claims which corresponds as closely as possible to the protective effect of the provisions of this Article 6.
- (10) Insofar as the value of the securities in place exceeds the value of the secured claims by more than 20 %, we shall release respective securities in order to avoid excessive security. The choice of the security to be released shall be at our discretion.

Article 7 Liability for defects

(1) Only applicable to consumers:

- a) If the goods are used movable items the claim for remedy (Nacherfüllung) of a material defect (Sachmangel) or a legal defect (Rechtsmangel) shall be subject to limitation of one year after the delivery of the item.
- b) The limitation for a claim for remedy in the case of a defect consisting in a right in rem (dingliches Recht) of a third party on the basis of which the surrender of the goods can be demanded, or in any right registered in the land register (Article 438 paragraph 1 No. 1 of the German Civil Code BGB), shall be reduced to a period of five years in the case of buildings and building materials as defined in Article 438 paragraph 1 No. 2 of the German Civil Code (BGB) and to two years in all other cases.
- c) In the case of works, the claim for remedy due to a material or legal defect shall be subject to limitation of one year upon statutory commencement of the limitation period, unless the goods are a building or works whose success consists in the provision of planning or supervision for it.
- d) After the expiry of the relevant period described in a), b) or c), any cancellation or reduction in price due to a defect shall also be excluded.
- e) Claims for damages by the Customer due to a material or legal defect shall be excluded insofar as:
 - the defect does not occur in a building or a building material as defined in Article 438 paragraph 1 No. 2 of the German Civil Code (BGB) and
 - the defect is caused by an act or omission of simple negligence and
 - the damage has not arisen due to death, physical injury or health impairment and
 - we are not liable on the basis of mandatory statutory provisions, for example under the Product Liability Act.
- f) Our contractual liability under any guarantee and any statutory liability due to the fraudulent concealment of a defect shall not be affected by the above restrictions.

The following paragraphs shall be applicable to enterprises only:

- (2) Under purchase contracts or contracts for manufacture and supply: if a material defect (Sachmangel) occurs, we shall be entitled to choose the way of remedy (Art der Nacherfüllung). This shall not affect our right to refuse remedy due to disproportionate costs pursuant to Article 439 paragraph 4 of the German Civil Code (BGB).
- (3) If the goods or works are located at a place other than the place of fulfilment at the time when remedy is requested, the Customer shall bear the additional costs incurred by remedy performed at this other place (for example transport costs and travelling expenses).
- (4) a) The Customer's entitlement to remedy in the event of material or legal defects in new goods or in works shall be subject to limitation one year upon statutory commencement of the limitation period, unless the goods or works are a building or works whose success consists in the provision of planning or

supervision of it, or a good which has been used for a building in accordance with its normal use and has caused a defect in the building.

- b) After expiry of the period specified in a), the rights to cancellation or price reduction due to defects shall be excluded.
- c) If a good is a used movable item, any claim for remedy as well as the rights to cancellation or price reduction due to defects shall be excluded.
- d) Claims for damages of the Customer due to material or legal defects in the goods or works shall be excluded insofar as the defect is caused by an act or omission of simple negligence. This shall not apply insofar as the damages have arisen due to death, physical injury or health impairment or as we are liable on the basis of mandatory statutory provisions, for example under the Product Liability Act.
- e) Our contractual liability under any guarantee and any statutory liability due to the fraudulent concealment of a defect shall not be affected by the above restrictions.
- (5) The restrictions on claims for remedy and the right to cancel the contract or reduce the price set out in paragraphs (2) to (4) shall not apply if the last contract in the supply chain is a consumer purchase (Verbrauchsgüterkauf). The limitation of our liability for damages shall not be affected.

Article 8 Other liability

The following shall apply to consumers and enterprises:

- (1) We shall be liable for death, physical injury or health impairment according to the statutory provisions. The same shall apply to all damages based on wilful misconduct (Vorsatz).
- (2) In the event of damages caused by breach of a substantial obligation (wesentliche Vertragspflicht) and which are not covered by paragraph (1), our liability shall be limited to the typical and foreseeable damage at the time of conclusion of the contract insofar as we are responsible for an act or omission of simple negligence. Substantial obligations are obligations the fulfilment of which make the proper execution of the contract in the first place and whose fulfilment the Customer regularly relies on.
- (3) For any such damages not covered by paragraphs (1) and (2), our liability shall be excluded insofar as we are responsible for an act or omission of simple negligence.
- (4) The above limitations of liability shall also apply in the event of fault (Verschulden) on the part of the persons named in Article 278 sentence 1 of the German Civil Code (BGB).
- (5) Our liability pursuant to mandatory statutory provisions such as the Product Liability Act (Produkthaftungsgesetz) shall remain unaffected.
- (6) The following shall additionally apply to enterprises: For damages not covered by paragraphs (1), (2) and (5), our liability for gross negligence shall be limited to the typical and foreseeable damage at the time of conclusion of the contract.

Article 9 Business secrets, data protection

- (1) The Customer shall treat as confidential all information and documents that we make available to it within the scope of the business relationship, unless these are also publicly available, or we expressly agree to their disclosure. This shall also apply to a quotation or offer prepared by us. The Customer shall take appropriate measures within its company to keep the probability of loss, unauthorised disclosure and data piracy as low as possible. Except for the goods or works, the Customer shall return to us all documents handed over or destroy such documents on our request or, in the case of electronic data, delete the data in such a way that they cannot be restored as far as technically possible. The statutory duties of the Customer to archive documents shall not be affected by this provision.
- (2) Data belonging to a party to the contract obtained during the business relationship, including personal data, may be stored by the other party to the contract as required. The Customer hereby declares its consent to any required transfer of the data, including personal data, to central departments within the group of companies (STREICHER Group) for the purpose of contract processing, legal advice and legal prosecution as well as for the fulfilment of duties under commercial and tax law.

Article 10 Place of jurisdiction, applicable law, partial invalidity

- (1) Disputes arising from or in connection with the contract shall be decided by the courts of ordinary jurisdiction. The place of jurisdiction shall be the competent court at the place of registered office of our company.
- (2) German law shall apply exclusively to all claims and rights arising from the contractual relationship and the statutory claims in connection with it. The conflict of laws rules of private international law and the UN Convention on Contracts for the International Sale of Goods (CISG) shall be excluded.
- (3) If one or more provisions of these GTCs are invalid or void in whole or in part, this shall not affect the other provisions.